

# Intrado Paging Relay

Audio Unicast to Multicast Conversion and so much more!

The Intrado Relay is a small PoE network appliance providing many features including unicast-to-multicast conversion - eliminating bandwidth-intensive unicast streams across WAN connections. The Paging Relay also enables analog systems, physical contacts, alarm panels, and more to integrate seamlessly with the Syn-Apps Revolution Notification Platform.



## How it Works

This patented device allows Revolution notifications to reach multicast devices over non-multicast enabled networks by leveraging the Paging Relay to broadcast a unicast stream to the local endpoints by rebroadcasting the notification in a multicast format.

The Paging Relay converts incoming streams from Revolution to multicast at the destination site and delivers the notification to the designated endpoints - IP phones, IP speakers, or traditional PA systems - via analog audio via RCA, or 600ohm interfaces. This is particularly useful in remote multi-site, WAN-connected voice networks.

## Features & Benefits

- Unicast-to-multicast conversion
- Auto registration to Revolution or SA-Announce via DHCP
- Up to 8MB on-board storage for audio files or stored announcements
- 600ohm and RCA line-out ports for overhead paging and analog systems
- RCA analog audio input used for Background Music and Music On Hold (MOH)
- SIP interface that allows SRST/CME failover support for enhanced redundancy
- Trigger notifications when activated via Sense-In port
- Web-based interface for customization and software upgrades
- Relay and Sensor Contact Closure functionality - Automatically play audio files, control door and window entries, activate sirens/strobes, and more!
- Accepts commands from 3rd party systems to activate locally stored audio to play, reducing bandwidth consumption in WAN deployments
- Gain control for integration with external audio input devices is controlled via software (v 3.5 units and higher)
- Stream analog audio to IP Multicast for background music when integrated with Revolution Notification Platform or Syn-Apps' legacy software, SA-Announce
- Automatic Gating
- Zone Paging\*
- Supports up to 10 simultaneous broadcast
- Local authentication services
- Night Ringer Functionality
- Direct Cisco ICM integration
- Standalone Paging Integration to 500 Cisco IP Phones\*

\*Requires Firmware 7.0 and above

## REQUEST A QUOTE

To learn more about any of our award-winning software or hardware for mass notification and paging solutions, please contact us at:

**Phone:** 1-866-664-6071  
**Email:** sales@syn-apps.com  
**Web:** www.syn-apps.com

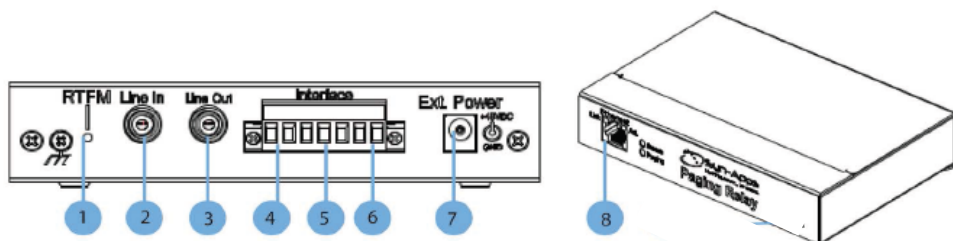

- 1 **RTFM Button** - When pressed momentarily the Relay will announce its IP address via the line-out ports / when held for 30 seconds the Paging Relay will default back to factory settings
- 2 **RCA Line In** - Accepts audio in from any standard external audio device / used for background music and/or music on hold
- 3 **RCA Line Out** - Relays audio from the line in port / will mute the line in audio when an active notification is being played
- 4 **Sense Contact** - Pins 1 & 2 : used to notify SA-Announce when a contact is closed / often connected to buttons, alarms, etc / SA-Announce can be configured to create a notification upon closure
- 5 **600ohm Audio Output** - Pins 3, 4 & 5: used to connect to external device requiring a 600ohm input (most analog paging amplifiers) / same functionality as RCA Line Out
- 6 **Relay Contact** - Pins 6 & 7: used to generate a contact closure/ used for wide range of door openers, strobes, beacons, audio amplifiers requiring a contact closure to activate an audio input, and more
- 7 **External Power Input** - Used to power the Relay if POE is not available, +48V power supply required
- 8 **Ethernet Port** - Connects relay to the network and if POE is available, powers the Relay

## TECHNICAL SPECS

The following is a list of technical requirements, product support and compatibility specifications:

### System Requirements:

- Revolution 2017.3.0+
- SA-Announce v.7.0 +

### Paging Relay Specifications:

- Ethernet I/F  
10/100 Mbps
- Power Input  
PoE(802.3af) or 48VDC
- Operating Temperature  
-30 to 55 C (-22 to 131 F)
- Dual Speed 10/100 Mbps  
G.711 u-Law, A-Law
- Regulatory Compliance  
FCC Class A, UL 60950. CE
- Dimensions  
6.11"L x 4.05"W x 1.15"H

## ABOUT US

Syn-Apps, now part of Intrado, is a leader in notification solutions designed to improve business processes, increase safety, and streamline internal and external communication.

Since 2001, thousands of organizations have integrated our notification and call-recording products with phones, paging systems, IP speakers and hundreds of other internal systems and services.

To learn more about our paging and mass notification solutions, visit us at [www.syn-apps.com](http://www.syn-apps.com).